

TO LET New Grade A Office Suites



-  Located in a new development in the Eastern Expansion Area of Milton Keynes
-  Junctions 13 & 14 of the M1 within a short drive
-  Milton Keynes Railway Station 4.4 miles
-  First and second floor offices of grade A quality with lift.
-  On street parking and private allocated parking.
-  Rent; Available upon application

From 1282 sq ft (119.10 sq m) to 2,564 sq ft (238.2 sq m)

25a & 25b, Highland Drive, Broughton Gate, Milton Keynes. MK10 7FA





Location

- Located in a prominent position at the southern end of Broughton Gate on Countess Way linking Broughton and Brooklands.
- Existing occupiers include a Co-Op and Jardines pharmacy
- Excellent access to the M1 motorway, and A421 trunk road.



Description

- Two new office units are available that can be combined to make one larger unit according to tenants requirements
- The 1st and 2nd floor units have an excellent fitout specification and have the benefit of a brand new fitout.

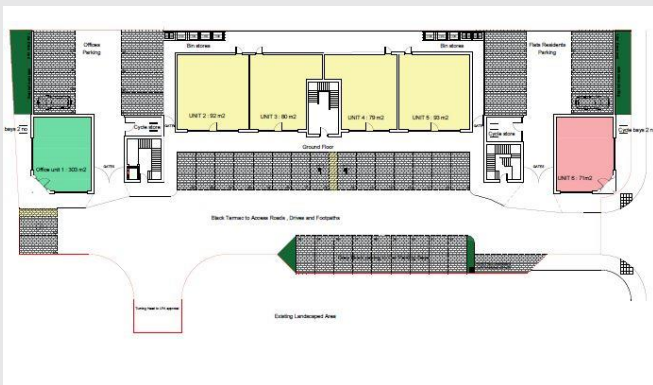

Specification

- Available with brand new suspended ceilings
- LED lighting.
- Comfort Cooling.
- Floor trunking.
- Open plan offices.
- Passenger lift.
- Fully carpeted.
- Balcony.
- New fitted kitchenette and WC.



Floor Area

The property has been measured in accordance with the RICS Code of Measuring Practice 6th Edition.

First floor offices: 119.1 sq m (1,282 sq ft)
 Second floor offices: 119.1 sq m (1,282 sq ft)

Total: 238.2 sq m (2,564 sq ft)

Areas quoted are approximate and should not be held as 100% accurate.



Terms

- The units are available with new FRI lease on terms to be agreed.
- Leasehold: Rent upon application.
- Service charge: Applicable.
- VAT: Applicable at the appropriate rate.



Business Rates

- Interested parties are advised to make their own enquiries.



Viewing

Nick Bosworth
nick.bosworth@kirkbydiamond.co.uk
 01908 678800

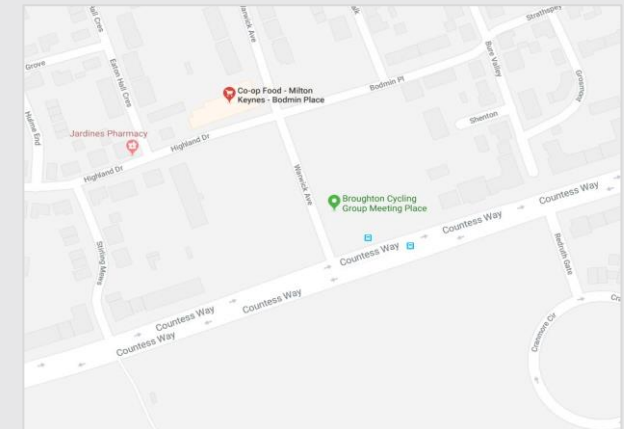

Misrepresentations Act:

Kirkby Diamond LLP for themselves and for the vendors, whose agents they are, give notice that these particulars are set out as a general guide only and do not constitute any part of any offer or contract. All descriptions, dimensions, reference to condition and the necessary permissions for use and occupation and other details are given in good faith and are believed to be correct but interested parties should not rely on them as statements or representations of fact but must satisfy themselves by inspection or otherwise as to the correctness of each of them. No person in the employment of Kirkby Diamond LLP has any authority to make or give any representation or warranty whatever in relation to this property.



the mark of
 property
 professionalism
 worldwide

